

BATCH NO:

PT4187
PT4188
PT4189

VIVEXOTIC

ASSEMBLY INSTRUCTIONS

REPTIHOMES
MEDIUM
ARBOREAL
VIVARIUM

MADE IN THE UK

Version 4

Important - Please read these instructions fully before starting assembly

If you need help, or have damaged or missing parts, please call **0141 945 2888** and ask for the QC department. However, please note if your product has been subject to obvious carrier damage to the carton during transit to your home, we recommend that you contact your supplier.

2 YEAR EXTENDED WARRANTY

You have automatically received a standard 12 month guarantee with your purchase, however will receive an extra 12 months free (giving you a total of 2 years warranty from the date of purchase), if you fill out your details online. Simply visit uk.hagen.com and click on the 'warranty' section.

The standard and extended warranty covers for defective parts which have failed under normal use. We shall not replace parts that have been damaged by abnormal conditions or that which have been subjected to improper use. It is important that you seal your vivarium to prevent moisture entering into exposed chipboard. We will not replace parts that have been water damaged due to insufficient sealing. If not sealed correctly, this will invalidate the warranty.

FITTINGS

Please note this fittings pack is used in different products, therefore it may include extra fittings that are not required in this product.

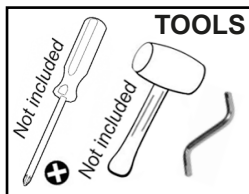

TOOLS

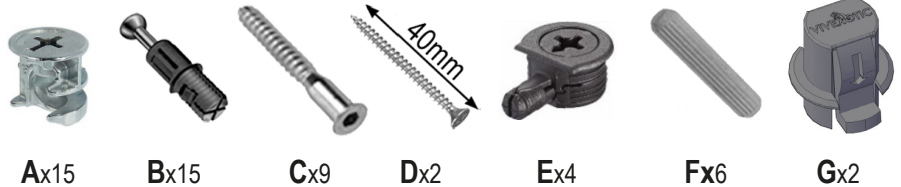

PREPARATION

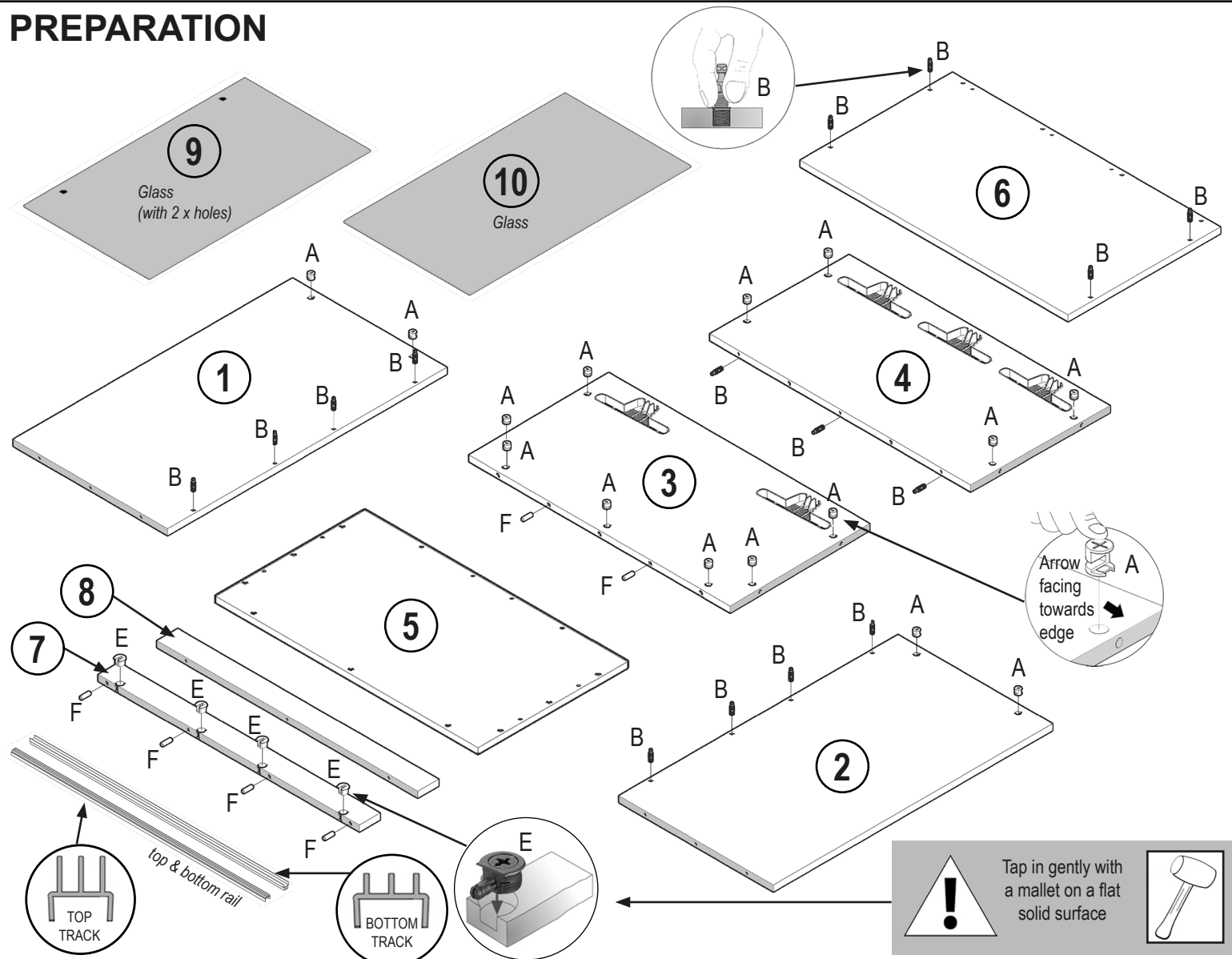

ASSEMBLY



i

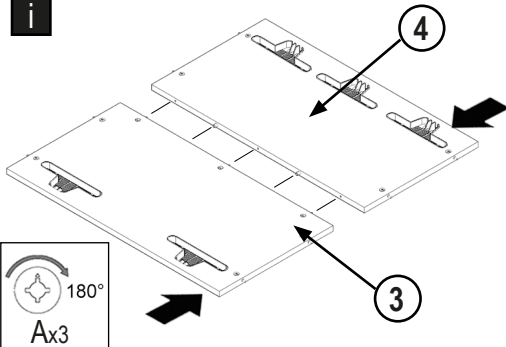

ii

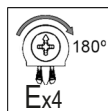

Fittings 'E' should be facing into the vivarium

For added strength, you could glue the 'E' dowels into the connecting holes



Insert dowel into connecting hole



Turn 180°
Dowel expands and grips into the connecting hole

iii

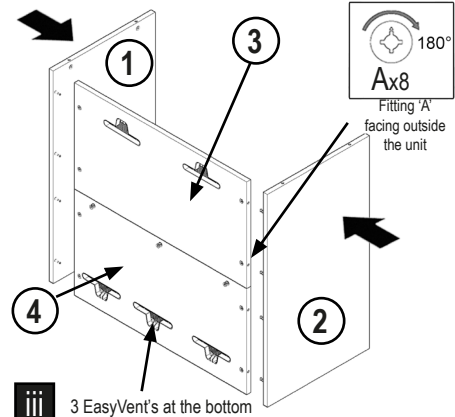

iv

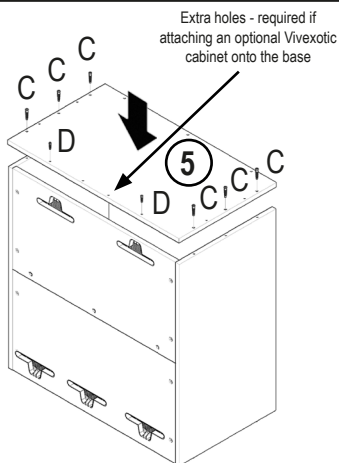

v

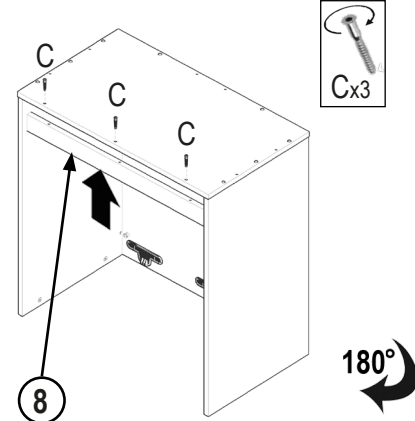

vi

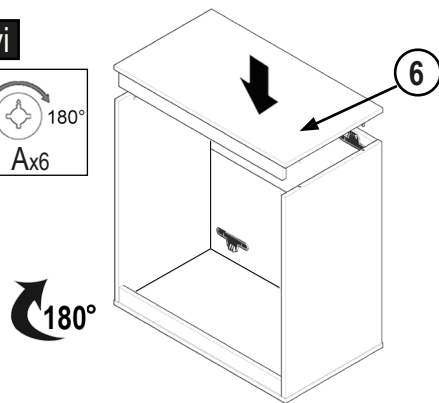
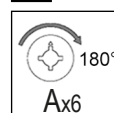

vii

STOP! At this point we recommend that you seal all joints and exposed fittings with a suitable silicon sealant, and leave overnight to cure.



viii

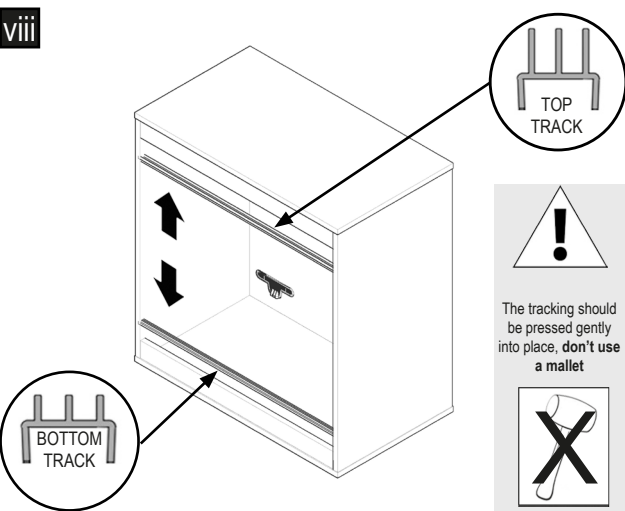

ix

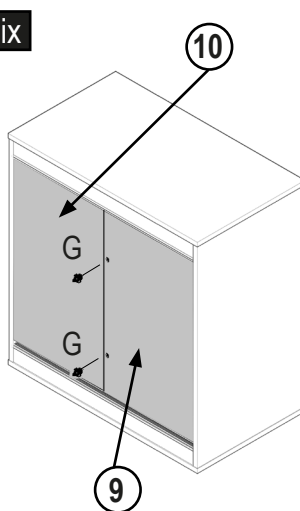

Lift glass up into the top tracks, and then drop down into the bottom

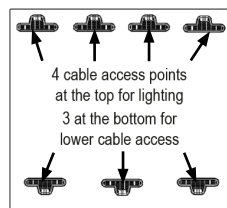

Each cable requires 1 channel

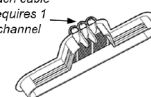

1. Take the EasyVent out of the back panel & remove caps from each channel required

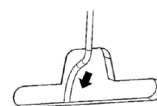

2. Pass plug through the hole in the back panel

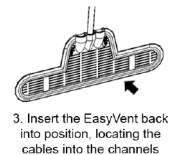

3. Insert the EasyVent back into position, locating the cables into the channels

This vivarium contains EasyVents. These vents allow all of your cables to pass through the vivarium. Simply pull the vent out, pass through any plugs, and put it back in position again... Easy!

Protecting Your Vivarium - Silicon Sealing

It is advised that once built, you seal all joints and exposed fittings with aquarium silicon sealant, and leave overnight to cure. This sealing will prolong the life of your vivarium and proactively safeguard against accidental water spills and pet wastes. If your pet requires misting, it is essential that no excess water is left pooling within the vivarium. If water is allowed to seep into exposed joints, gaps or inadequately sealed edges the wood will swell.

We strongly recommend that the vivarium is sealed fully after construction, particularly where humidity levels are high. We recommend that humidity levels do not exceed 65% in any wooden vivarium and cannot guarantee the longevity of the vivarium in this case. For species requiring high levels of humidity we recommend Exo Terra Glass Terrariums. Please visit www.exo-terra.com for more details.

Please visit vivexotic.co.uk for more information

We recommend Exo Terra reptile accessories for use with Vivexotic products. Please refer to the 'Exo Terra Essential Care & Equipment Guide' included for further details.



Vivexotic Medium Cabinet

A matching Vivexotic cabinet can also be purchased to fit directly onto the base of this vivarium.

PT4068

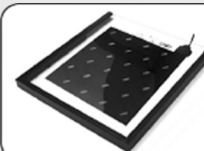

Safely mount heat mats inside your melamine vivarium with a Vivexotic Heat Mat Holder.

PT4047



The stainless steel Vivexotic Glass Door Lock & Key provides a secure locking system for your reptile.